

## Zeno Up Frosted

design  
Jan Van Lierde

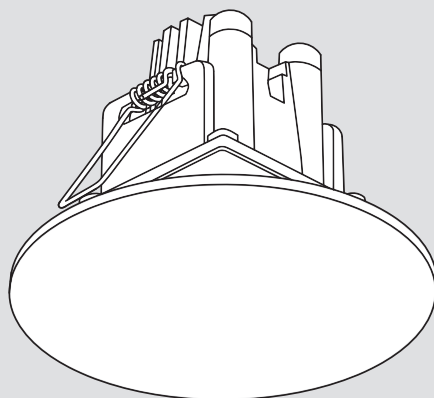

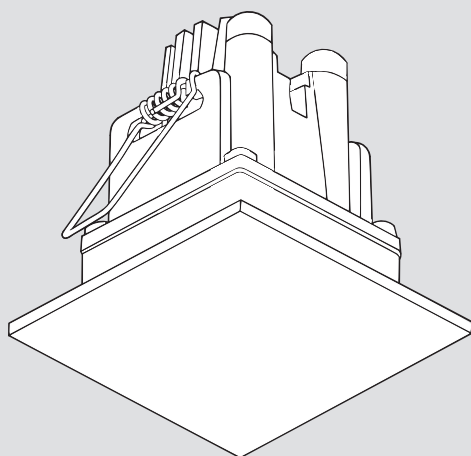
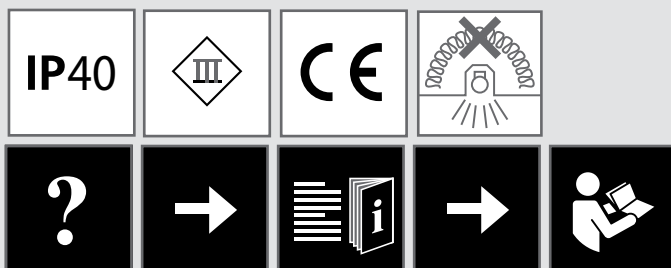

Zeno Up 2  
Frosted

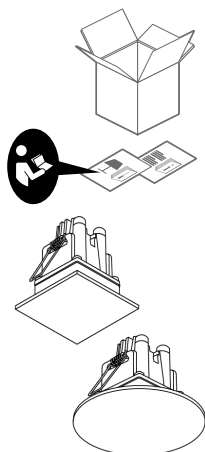

**LED 0**



Zeno Up 3  
Frosted

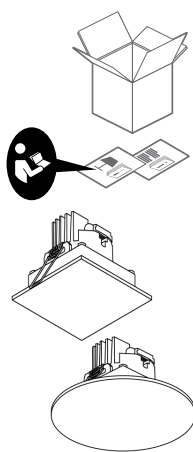

**LED 1**  
from  
Dthr 95 cm



Zeno Up 4  
Frosted

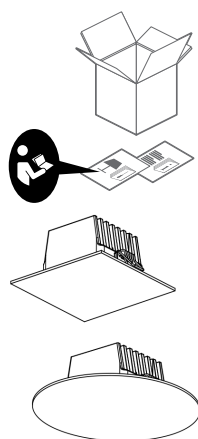

**LED 0**

Zeno Up 2 Frosted Round

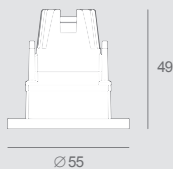

Zeno Up 2 Frosted Square

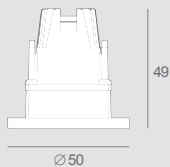

Zeno Up 3 Frosted Round

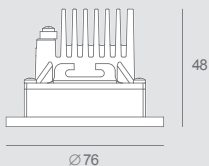

Zeno Up 3 Frosted Square

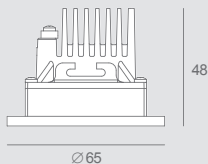

Zeno Up 4 Frosted Round

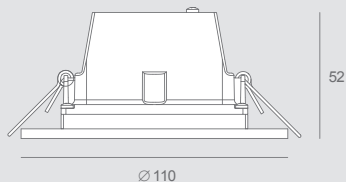

Zeno Up 4 Frosted Square

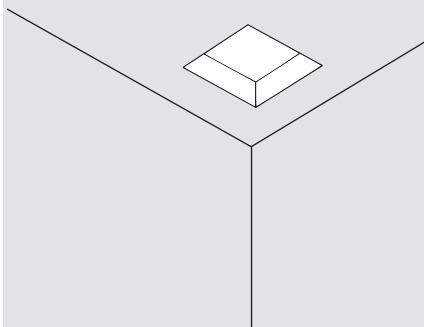
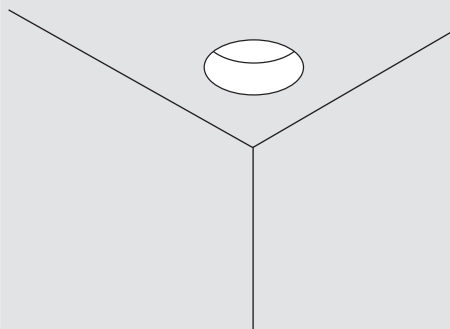
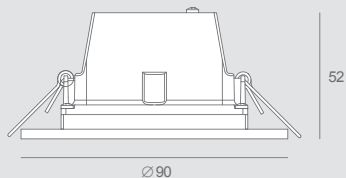

Zeno Up 2 Round:  $\varnothing 49 \pm 2\text{mm}$

Zeno Up 3 Round:  $\varnothing 70 \pm 2\text{mm}$

Zeno Up 4 Round:  $\varnothing 103 \pm 2\text{mm}$

Zeno Up 2 Square:  $\square 38 \times 36 \pm 2\text{mm}$

Zeno Up 3 Square:  $\square 56 \times 52 \pm 2\text{mm}$

Zeno Up 4 Square:  $\square 79 \times 79 \pm 2\text{mm}$

# Zeno Up Frosted IP40

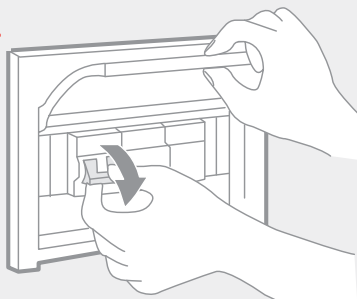

1

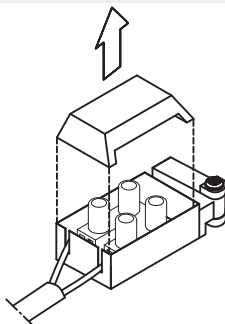

2a

Zeno Up 3 Frosted

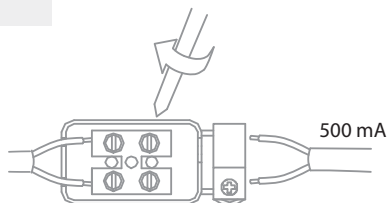

⊕ rosso / red / rouge / rot  
⊖ nero / black / noir / schwarz

2a

Zeno Up 2 Frosted  
Zeno Up 4 Frosted

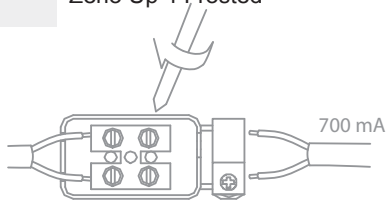

⊕ rosso / red / rouge / rot  
⊖ nero / black / noir / schwarz

3

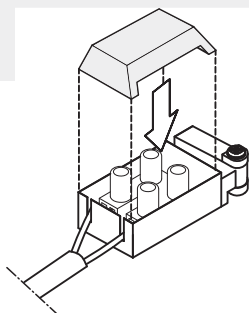

4

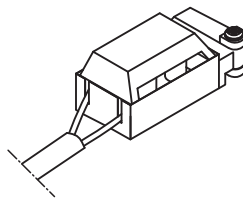

Collegamento in serie - Series connection - Connection en série  
Hintereinander schaltung - Conexion en serie



Per evitare di danneggiare il led effettuare tutti i collegamenti prima di dare tensione.

To avoid damages to led unit all connection shall be made before to switch power on.

Pour éviter d'endommager le conduit à faire toutes les connexions avant d'appliquer le pouvoir.

Um eine beschädigung der led zu vermeiden, bitte produkte erst nach dem anschluss einschalten.



5

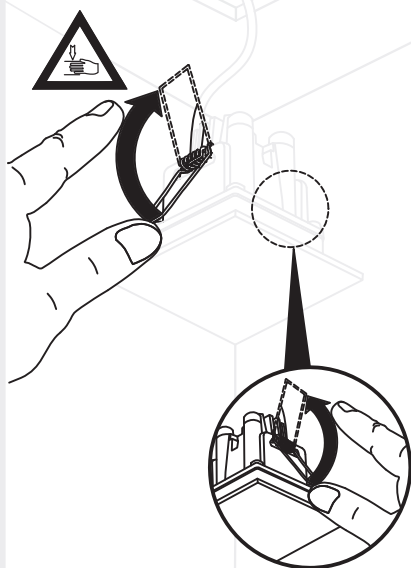

6

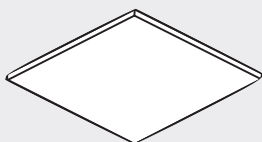
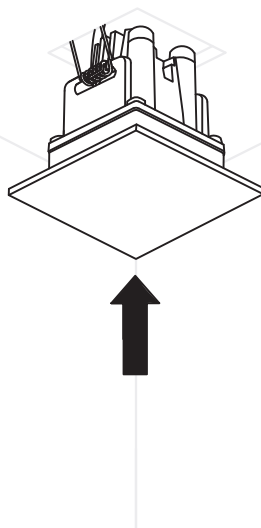



1

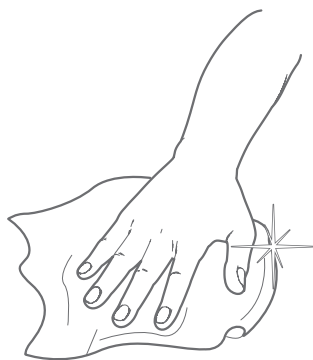

1





## **Artemide Spa**

via Bergamo, 18  
20010 Pregnana M.se (MI)  
ITALIA

Tel. +39 02 935 181  
Fax +39 02 935 90 254  
Fax +39 02 935 90 496

[www.artemide.com](http://www.artemide.com)

VAT IT00846890150